

T 19S R 8E M W

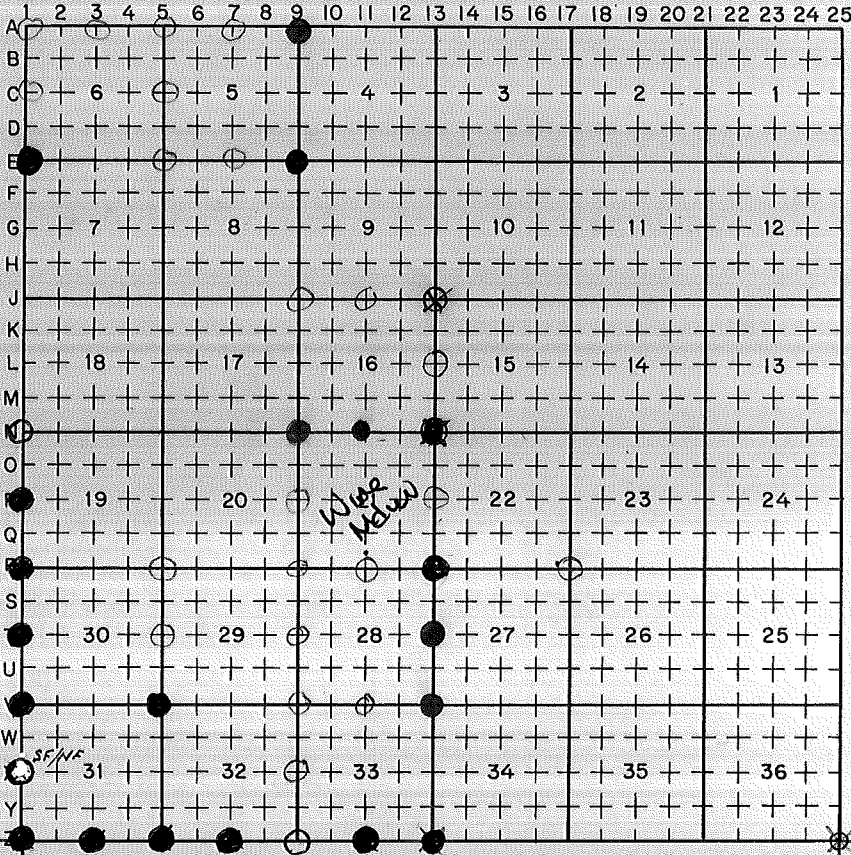

LEGEND

○ = Corner having information on form 7100-52 in this file.

Legend conforms to Reporting Form 4/27/59

FILING INSTRUCTION

File 7100-52 card record by letter and number coordinates behind the file guide for the township in which it falls.

File the 7100-52 card record by letter and then by number i.e., all A cards first, then B cards etc.

The first card behind the file guide (if data have been obtained and recorded) will be card A-1 for N.W. Township Corner, then card A-2 for 1/16 corner then card A-3 for 1/4 corner etc.

19 | 8 S.22 Wire Mdw.
TRACT OR SURVEY NO. Spec

SURVEY DIAGRAM

See Plat No 1029
IN Hanging File

LEGEND

○ = Corner having information on form
7100-52 in this file.

FILING INSTRUCTIONS

Draft tract diagram in space at left.
File 7100-52 card record in numerical
sequence behind tract file guide as the
data are obtained and recorded. Show
by above symbol, on the tract diagram
those corners having data in this file.

USDA-FOREST SERVICE

Index File No. 0951

CORNER RECORD (SEARCH)

(Ref. FSM 7151.4)

Tract or Survey No. _____

Cor. No. A-09

T 195 R. 8E

R.D. Bend County Deschutes

Deschutes

NW Cor

Merid. WMT

N.F. Deschutes State Oregon

Oregon

Sec 4

CORNER DIAGRAM

DESCRIBE CORNER MONUMENT FOUND

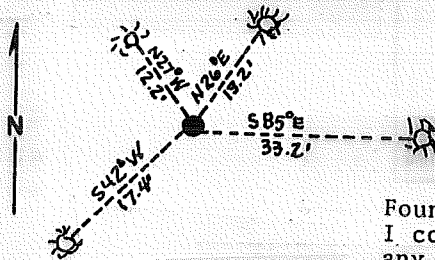

DESCRIBE BEARING TREES OR OTHER OFFICIAL ACCESSORIES FOUND

Found bedded stone 16x10x9 with 4 visible notches on the east edge. I could not discern the notches on the west edge. The only remains of any of the bearing trees was a stump hole in the SW location.

PHOTO IDENTIFICATION DATA

Photo No. _____

Filed At. _____

Object Ident. _____

Ident. By _____

Signature

DESCRIBE CORNER LOCATION RELATIVE TO NEAR-BY FEATURES, ALSO HOW TO REACH CORNER

PLANE COORDINATE POSITION DATA

State _____ Zone _____

X _____

Y _____

Estab. By _____

Agency

Signature

Title

Division

Headquarters

Date

FS-7100-52 (3/68)

Walt Miller

PLS

CS

SO

9/95

CORNER RECORD (PERPETUATION)

MONUMENT: DESCRIBE NEW MONUMENT SET, OR WORK DONE TO PRESERVE EXISTING MONUMENT

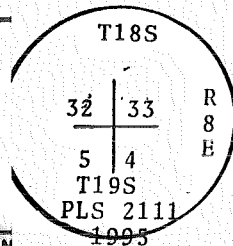

In the place of the stone, I set a 2-1/2" Aluminum Capped Aluminum Pipe rising 3", from which I established the following accessories.

A 6" Lodgepole Pine bears N26°E at 13.2 ft., marked T18S R8E S33 BT.

A 4" Lodgepole Pine bears S85°E at 33.2 ft., marked X BT.

A 8" Lodgepole Pine bears S42°W at 17.4 ft., marked T19S R8E S5 BT.

A 4" Lodgepole Pine bears N27°W at 12.2 ft., marked X BT.

EXISTING

A brass washer marked PLS 2111 was installed in the accessories between the scribed 'B' and 'T' of the blaze. Distances to the accessories were measured to side-center.

Work Done By Walt Muller Title PLS Date 9/95 State Registration No. 2111
or Agency

Certified Cor. Record Prepared? Yes No Filed At: Des. Co. Date —

July 25, 1882 - Samuel W. Lackland under Group No. 458, established the the North line of T19S, R8E. He set this corner as follows:

Set Slate Stone 16x12x10 ins 9 ins in ground for cor to Secs 4,5,32 and 33 marked with 4 notches on E and 2 notches on W edge from which,

A B. Pine 10 ins diam bears S45W 23 lks dist. marked T19S.R8ES5BT.

A B. Pine 6 ins diam bears S40E 26 lks dist, marked T19S.R8ES4BT.

A B. Pine 8 ins diam bears N82W 33 lks dist, marked T18S.R8ES32BT.

A B. Pine 6 ins diam bears N49E 21 lks dist, marked T18S.R8ES33BT.

Index File No. T. R. M. Tract or Surv. No. Cor. 12 13

0951

19 8

GPO: 1986 O-439-095

A-09

Index File No. 0955

CORNER RECORD (SEARCH)

(Ref. FSM 7151.4)

Tract or Survey No. _____

Cor. No. E-09

T 195 R. 8 E

R.D. Bend County Deschutes

SW/A Sec. 4

Merid. WMT

N.F. Deschutes State Oreg

CORNER DIAGRAM

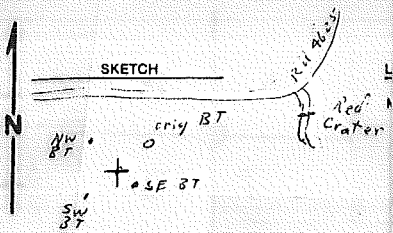

T195 R8E

PHOTO IDENTIFICATION DATA

Photo No. _____

Filed At. _____

Object Ident. _____

Ident. By _____

Signature

PLANE COORDINATE POSITION DATA

State _____ Zone _____

X _____

Y _____

Estab. By _____

Agency

DESCRIBE CORNER MONUMENT FOUND

SF/NF

DESCRIBE BEARING TREES OR OTHER OFFICIAL ACCESSORIES FOUND

DESCRIPTION OF CORNER EVIDENCE FOUND:

No evidence of original stone, corner position determined from NE BT which is a Lodgepole Pine, 20" dia., N.52°E., 52 lks. (54.5 ft.), scribing exposed. No evidence of other BT's. Corner falls on a lava ridge.

DESCRIBE CORNER LOCATION RELATIVE TO NEAR-BY FEATURES, ALSO HOW TO REACH CORNER

Signature

B. H. Ham

Title

PLS

Division

CS

Headquarters

SO

Date

10/94

FS-7100-52 (3/68)

CORNER RECORD (PERPETUATION)

MONUMENT: DESCRIBE NEW MONUMENT SET, OR WORK DONE TO PRESERVE EXISTING MONUMENT

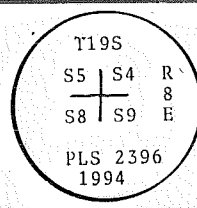

A 2½"dia. Alum. pipe, 30" long surmounted by a 2½"dia. alum cap, rising 28", in a mound of stone. A penny at base of pipe. A 6ft. steel fence post is 3ft South.

A Lpp. 20"dia., N.32°E., 34.3ft., Original BT, Not re-marked

A Lpp. 8"dia., S.50°E., 19.1ft., mkd. T19S R8E S9 BT

A Lpp. 9"dia., S.68°W., 38.2ft., mkd. T19S R8E S8 BT

A Fir. 4"dia., N.49°W., 37.0ft., mkd. X BT

A brass washer marked LS 2396 nailed between the B & T of the scribing. Bearings by hand compass. Distances to side center at root crown. Location poster on Rd. 4625 approx.300 ft. North of corner.

LINE TO PRESERVE EXISTING EVIDENCE

Work Done By William B Ham Title PLS Date 10/94 State Registration No. 2396
or Agency _____

Certified Cor. Record Prepared? Yes No Filed At: Des. Date 10/3/94

REMARKS

Survey of 1885 by Samuel W. Lackland
GLO Record- Set basalt stone 16x12x10 ins. 10ins. in the ground for cor. to secs. 4,5,8 & 9 marked with 5 notches on S. & 4 notches on E. edges; from which
A B.Pine 10 ins. dia. brs. N.32°E. 52 lks. dist. marked T.19S.R.8E.S.4B.T.
A B.Pine 8 ins. dia. brs. S.86°E. 44 lks. dist. marked T.19S.R.8E.S.9B.T.
A B.Pine 10 ins. dia. brs. S.40°W. 16 lks. dist. marked T.19S.R.8E.S.8B.T.
A B.Pine 12 ins. dia. brs. N. 2°W. 65 lks. dist. marked T.19S.R.8E.S.5B.T.

Index File No. 0955 T. 19 R. 8 WMT Tract or Surv. No. _____ Cor. E-09
GPO: 1986 O- 439-095

Index File No. _____

CORNER RECORD (SEARCH)

(Ref. FSM 7151.4)

Tract or Survey No. _____

Cor. No. E-25

T 195 R. 8E

R.D. Bend/FT Rock County Deschutes

S.E. Sec 1

Merid. WM

N.F. Deschutes State OR

CORNER DIAGRAM

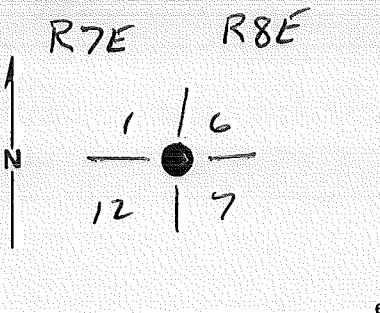

DESCRIBE CORNER MONUMENT FOUND

FD sand stone 13x13x6 marked w/ 5 grooves on South & 1 on North Faces in a mound of stone

DESCRIBE BEARING TREES OR OTHER OFFICIAL ACCESSORIES FOUND

NE - A Pine windfall N 70°E 33 Lks w/ Face scribing
 SE - Pine snag 17" Dia S 22°E 15 " " " "
 SW - Pine windfall S 48°W 37 Lks " " "
 NW - Fir windfall N 78 W 21 Lks " " "

Note High scribing - "T" in BT was 18" above ground

DESCRIBE CORNER LOCATION RELATIVE TO NEAR-BY FEATURES, ALSO HOW TO REACH CORNER

"X" chopped in tree on North side of trail & blazed trees North approx 900' into cor. Wooden location poster on trail

PHOTO IDENTIFICATION DATA

Photo No. _____
 Filed At. _____
 Object Ident. _____
 Ident. By _____
 Signature _____

PLANE COORDINATE POSITION DATA

State _____ Zone _____
 X _____
 Y _____
 Estab. By _____
 Agency _____

Signature S. L. Hunt Title Sur Tech Division CS Headquarters Bend/50 Date 10/16/98 FS-7100-52 (3/68)

CORNER RECORD (PERPETUATION)

MONUMENT: DESCRIBE NEW MONUMENT SET, OR WORK DONE TO PRESERVE EXISTING MONUMENT

Set 2 1/2" Dia x 30" long ACAP rising 6" in mound of stone
Orig. stone buried along side

Steel post 3' North

ACCESSORIES : DESCRIBE NEW BT'S WITNESS OBJECTS ETC. ESTABLISHED, OR WORK DONE TO PRESERVE EXISTING EVIDENCE

L P Pine	7" Dia	N 44° E	32.0 FT	marked X BT
L P Pine	" "	S 71° E	24.1 "	" T195 R 8E S7 BT
SubAlpine Fir	4 "	S 75 W	17.5 "	" X BT
Hemlock	15 "	N 83° W	42.5 "	" T195 R 7E S1 BT

Work Done By W B Ham Title PLS Date _____ State Registration No. or Agency _____

Certified Cor. Record Prepared? Yes No Filed At: _____ Date _____

REMARKS

Orig: set sandstone 15x14x10 ins 7 ins in ground for cor
Secs 1, 6, 7 1/2, 12. marked w/ 5 notches on S 1/4 on N edge from ~~cut~~ which
A Pine 14" dia S 48° W 29 LKS marked T195 R 7E S12 BT
A Pine 20 " S 29° E 15 LKS " T195 R 8E S7 BT
" 22 " N 70° E 33 LKS " T195 R 8E S6 BT
A Fir 18 " N 82 W 21 LKS " T195 R 8E S6 BT

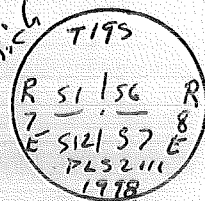

Index File No. T. 195 R. 8E M. W M Tract or Surv. No. _____ Cer. E-25

USDA-FOREST SERVICE

Index File No. _____

CORNER RECORD (SEARCH)

(Ref. FSM 7151.4)

Tract or Survey No. _____

Cor. No. J-13

T 19 S R. 8 E

R.D. Bend County Deschutes

Merid. Wil

N.F. Deschutes State OR

CORNER DIAGRAM

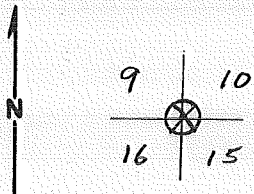

DESCRIBE CORNER MONUMENT FOUND

orig. stone of call size in mound of stone

DESCRIBE BEARING TREES OR OTHER OFFICIAL ACCESSORIES FOUND

(10.1')
 Lp. Pine wind fall 5" dia. N21°E. 15 LKS. w/ scribing visible
 No evidence of SW BT
 Lp. Pine wind fall 6" dia. S72°W. 32 LKS. (21.0') w/ scribing visible
 No evidence of N.W. BT.

PHOTO IDENTIFICATION DATA

Photo No. _____
 Filed At. _____
 Object Ident. _____
 Ident. By _____
 Signature _____

DESCRIBE CORNER LOCATION RELATIVE TO NEAR-BY FEATURES, ALSO HOW TO REACH CORNER

Loc. Tag on trail 1100 ft. W. of Cor.

PLANE COORDINATE POSITION DATA

State _____ Zone _____
 X _____
 Y _____
 Estab. By _____
 Agency _____

Signature W H SK MW

Title

Division

Headquarters

Date 9/15/94

FS-7100-52 (3/68)

CORNER RECORD (PERPETUATION)

MONUMENT: DESCRIBE NEW MONUMENT SET, OR WORK DONE TO PRESERVE EXISTING MONUMENT

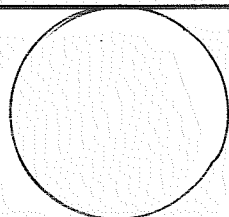

ACCESSORIES : DESCRIBE NEW BT'S WITNESS OBJECTS ETC. ESTABLISHED, OR WORK DONE TO PRESERVE EXISTING EVIDENCE

Lp. Pine 13" dia. N 65° E 11.0 ft. mKd T 195 R 8 E S 10 BT
 Lp. Pine 7" dia. S 24° E 46.9 ft. mKd T 195 R 8 E S 15 BT
 Lp. Pine 7" dia S. 61° W 9.7 ft. mKd T 195 R 8 E S 16 BT
 Lp. Pine 4" dia. N 23° W 19.2 ft. mKd X BT.

Work Done By _____ Title _____ Date _____ State Registration No. or Agency _____

Certified Cor. Record Prepared ? Yes No Filed At: _____ Date _____

REMARKS

Index File No. T. R. M. Tract or Surv. No. Cor. 12

USDA-FOREST SERVICE

Index
File No. 0163

CORNER RECORD (SEARCH)
(Ref. FSM 7.151.4)

Tract or
Survey No. _____

Cor.
No. N-01

T. 19 S. R. 8 E. R.D. BEND

County DESCHUTES

NW COR. of SEC. 19

Merid. WILLAMETTE

N.F. DESCHUTES

State OREGON

SE COR. of SEC. 13

CORNER DIAGRAM PER LEGEND

DESCRIBE CORNER MONUMENT FOUND

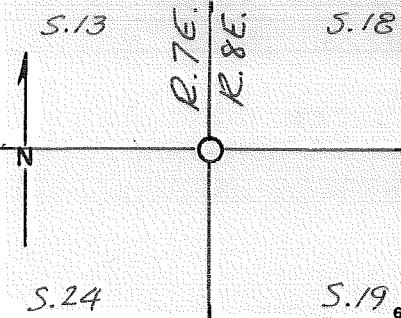

SF/NF

DESCRIBE BEARING TREES OR OTHER OFFICIAL ACCESSORIES FOUND

SF/NF

PHOTO IDENTIFICATION DATA

Photo No. _____

Filed At. _____

Object Ident. _____

Ident. By _____

Signature

DESCRIBE CORNER LOCATION RELATIVE TO NEAR-BY FEATURES, ALSO HOW TO REACH CORNER

Corner Legend:

Searched for/Not Found

Evidence Found/Accept.

Permanent Monument

Signature W. MILLER

Title S.T.

Division _____

Headquarters S.O.

Date 9/81 O-7100-52 (3/79)

CORNER RECORD (PERPETUATION)

MONUMENT. DESCRIBE NEW MONUMENT SET, OR WORK DONE TO PRESERVE EXISTING MONUMENT

MONUMENT STAMPED

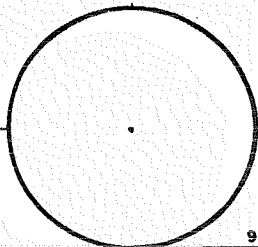

ACCESSORIES DESCRIBE NEW BT'S WITNESS OBJECTS ETC. ESTABLISHED, OR WORK DONE TO PRESERVE EXISTING EVIDENCE

Work Done By _____ Title _____ Date _____ State Registration No. or Agency _____

PLAT PREPARED OR
Certified Cor. Record Prepared? Yes No Filed At: Co. SURVEYOR'S OFFICE Date

ORIG.: SANDSTONE 14 X 14 X 8 BURIED 7", w/ 3 NOTCHES N & S
REMARKS
BT'S: 9" FIR N10E 86 FT
12" FIR S79E 25 1/2 FT.
14" FIR S55W 26 1/2 FT.
10" FIR N32W 13 1/2 FT.

Index File No. 0163 T. 19 S., R. 8 E., W.M.

Tract or Surv. No.

Cor. N-01 13

USDA-FOREST SERVICE

Index
File No. 1163

CORNER RECORD (SEARCH)

(Ref. FSM 7151.4)

Tract or
Survey No. _____

Cor.
No. N-11

T 19 S R. 8 E

R.D. Bend

County Deschutes

WC TO N/4

Merid. WMT

N.F. Deschutes

State Oregon

Sec. 21

CORNER DIAGRAM

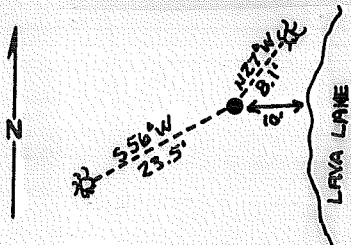

DESCRIBE CORNER MONUMENT FOUND

Found bedded stone 17x10x7, 10 feet west of lake shore. The stone was marked WC 1/4 on the E. face. There were rotted remains of the NW tree but found no marks. There was a stump hole in the SW location.

PHOTO IDENTIFICATION DATA

Photo No. _____

Filed At. _____

Object Ident. _____

Ident. By _____

Signature

7

DESCRIBE CORNER LOCATION RELATIVE TO NEAR-BY FEATURES, ALSO HOW TO REACH CORNER

3

PLANE COORDINATE POSITION DATA

State _____ Zone _____

X _____

Y _____

Estab. By _____

Agency

8

Signature

Title

Division

Headquarters

Date

FS-7100-52 (3/68)

4

Walt Miller

PLS

CS

SO

9/95

5

CORNER RECORD (PERPETUATION)

MONUMENT: DESCRIBE NEW MONUMENT SET, OR WORK DONE TO PRESERVE EXISTING MONUMENT

I set a 2½" X 30" Aluminum Capped Aluminum Pipe in the position of the stone rising 4" in a stone mound. I buried the original stone alongside. I established accessories as follows:

- A 10" Lodgepole Pine bears N27°E at 8.1 feet, marked X WC BT.
- A 6" Lodgepole Pine bears S56°W at 23.5 feet, marked X BT.

I installed brass washers marked PLS 2111, in the blaze between the scribed B and T. Distances were measured to side-center of the trees.

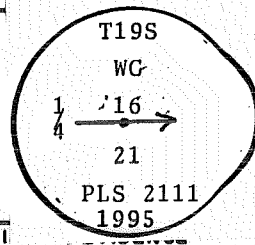

E EXI

10

Work Done By Walt Miller Title PLS Date 9/95 State Registration No. 2111
or Agency

Certified Cor. Record Prepared? Yes No Filed At: Des. Co. Date

11

REMARKS

July 25, 1995 - Samuel W. Lackland under Group No. 458, established the sectional subdivision lines for T19S, R8E. He set this corner as follows:

Set granite stone 18x14x10 ins. 12 ins. in ground for witness cor. to 1/4 sec. marked W.C. 1/4 on N. face: from which

- A B.Pine 10 ins. dia. brs. N.77°W. 27 lks. dist. marked W.C.1/4S.B.T.
- A B.Pine 12 ins. dia. brs. S.73°W. 28 lks. dist. marked W.C.1/4S.B.T.

12

Index File No.	T.	R.	M.	Tract or Surv. No.	Cor.
WC 1163	19	8	GPO: 1986 O- 439-095		WC N-11

13

USDA-FOREST SERVICE

Index File No. _____

CORNER RECORD (SEARCH)

(Ref. FSM 7151.4)

Tract or Survey No. _____

Cor. No. N-13

T 19 S R. 8 E

R.D. Bend

County Deschutes

NW Cor. S.22

Merid. Wil

N.F. Deschutes

State OR

CORNER DIAGRAM

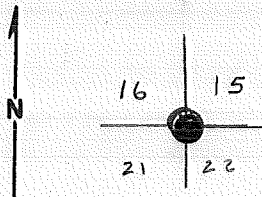

DESCRIBE CORNER MONUMENT FOUND

Found Basalt stone 17" X 9" X 8" clearly marked with 3 grooves on East & with

DESCRIPTION OF CORNER EVIDENCE FOUND:

- D A basalt stone 17"x9"x8" clearly marked with 3 grooves on the East and with 3 faint notches on South edges.
- , A Lodgepole pine windfall 10" dia., N.35°E. 30 lks.(19.8 ft.) with scribing visible. Remains of a pine in SE BT locations.
- A stump hole in SW BT location.
- K Rotted remains of a pine in NW BT location.

11/17/97

S

Rotted remains of a pine in N.W. location

PHOTO IDENTIFICATION DATA

Photo No. _____

Filed At. _____

Object Ident. _____

Ident. By _____

Signature

7

PLANE COORDINATE POSITION DATA

State _____ Zone _____

X _____

Y _____

Estab. By _____

Agency

8

DESCRIBE CORNER LOCATION RELATIVE TO NEAR-BY FEATURES, ALSO HOW TO REACH CORNER

Approx. 50 ft. N. of trail.

See Cert update on Back (11/17/97 - W. Miller)

Signature WJ

Title

Division

Headquarters

Date 8/18/94

FS-7100-52 (3/68)

5

CORNER RECORD (PERPETUATION)

MONUMENT: DESCRIBE NEW MONUMENT SET, OR WORK DONE TO PRESERVE EXISTING MONUMENT

MONUMENT DETAIL

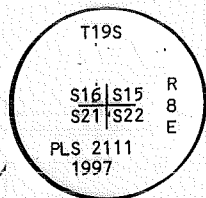

SKETCH

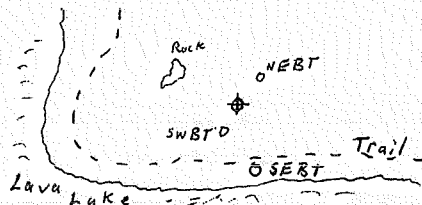

LOCATION / COMMENTS:

MAG. DECL. 19° E

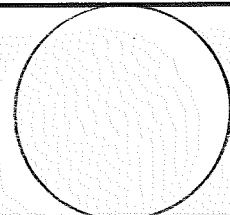

WORK DONE TO PRESERVE EXISTING EVIDENCE

- 1 X BT
- 2 X BT (on S. edge of Trail)
- T19S, R8E S21 BT
- 24 N 79°W. 90.8'

DESCRIPTION OF MONUMENT AND ACCESSORIES ESTABLISHED:

Set a 2 1/2" dia. x 30" steel pipe surmounted by a 2 1/2" dia. brass cap rising 6". Original stone buried alongside. Steel fence post 3 ft. North.
 A Lodgepole Pine 8" dia. N.46°E., 8.1 ft., mkd. X BT
 A Ponderosa Pine 32" dia. S.6° E., 85.3 ft. mkd. X BT
 A Lodgepole Pine 9" dia. S.37°W., 10.6 ft. mkd. T19S R8E S21 BT
 A PK nail in a rock outcrop 9'x8.5'x4' N.79°W., 40.8 ft., mkd. B0.

Lake shore trail approx. 60 ft. South of cor. Lake shore approx. 105 ft. South of corner. Corner and BT's were camouflaged due to the proximity of the trail.

State Registration No. 2111
 Agency _____

Certified Cor. Record Prepared ? Yes No Filed At: _____

Date _____

REMARKS

Survey of 1883 by Samuel W. Lackland
 GLO Record - Set sandstone 18x9x8 ins. 12 ins. in ground for cor. to secs 15, 16, 21 & 22 marked with 3 notches on S. & E. edges; from which:
 A B. Pine 10 ins. dia. brs. N.35°E. 30 lks. dist. marked T.19S.R.8E.S15 B.T.
 A B. Pine 7 ins. dia. brs. S.40°E. 3 lks. dist. marked T.19S.R.8E.S.22. B.T.
 A B. Pine 10 ins. dia. brs. S.39°W. 49 lks. dist. marked T.19S.R.8E.S.21 B.T.
 A B. Pine 5 ins. dia. brs. N.73°W. 12 lks. dist. marked T.19S.R.8E.S.16 B.T.

Index File No. _____

T. _____

R. _____

M. _____

Tract or Surv. No. _____

Cor. _____

USDA-FOREST SERVICE

Index File No. 0165

CORNER RECORD (SEARCH)

(Ref. FSM 7.151.4)

Tract or Survey No. BLM 1000

Cor. No. P-01

T. 19 S. R. 8 E. R.D. BEND County DESCHUTES W/4 COR. of SEC. 19
 Merid. WILLAMETTE N.F. DESCHUTES State OREGON E/4 COR. of SEC. 24

CORNER DIAGRAM PER LEGEND

S. 24

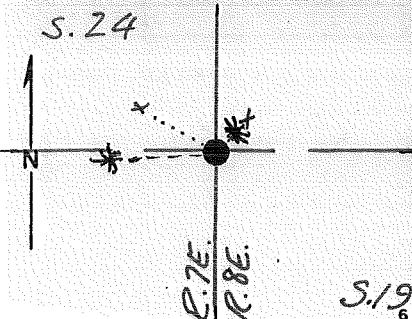

DESCRIBE CORNER MONUMENT FOUND

STONE 18" X 12" X 6" MKD. 4 ~ FLUSH w/
GROUND LEVEL

DESCRIBE BEARING TREES OR OTHER OFFICIAL ACCESSORIES FOUND

S. 19: 12" HEMLOCK N 44° E 3 1/2 FT. ~ VIS: FACE BLAZE
 S. 24: 9" " SNAG N 68° W 8 1/2 FT. " " "

PHOTO IDENTIFICATION DATA

Photo No. _____
 Filed At. _____
 Object Ident. _____
 Ident. By _____

Signature

DESCRIBE CORNER LOCATION RELATIVE TO NEAR-BY FEATURES, ALSO HOW TO REACH CORNER

PLACED BT TAGS ON BTs

Corner Legend:

- Searched for/Not Found
- Evidence Found/Accept.
- Permanent Monument

Signature W. MILLER

Title S.T.

Division _____

Headquarters S.O.

Date 9/81 D-7100-52 (3/79)

CORNER RECORD (PERPETUATION)

MONUMENT SET

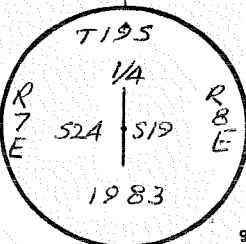

MONUMENT. DESCRIBE NEW MONUMENT SET, OR WORK DONE TO PRESERVE EXISTING MONUMENT

SET 2 1/2" X 30" ACAP RSG. 7" IN A MOUND OF STONE,
2 1/2' X 18" high, ON A GENTLE ~~WEST~~ SLOPE, BURIED
ORIG. STONE ALONGSIDE PIPE

9

ACCESSORIES DESCRIBE NEW BT'S WITNESS OBJECTS ETC. ESTABLISHED, OR WORK DONE TO PRESERVE EXISTING EVIDENCE

15" W. FIR S 89 1/2° W 27.5° FT. TO 60d NL. IN S. BASE, MKD. 1/4 S 24 BT
12" W. FIR. N 44 1/4° E 4.00 FT. TO 60d NL. IN NW BASE, (ORIG.).

10

Work Done By R. ROMAN Title PLS Date 10/82 State Registration No. OR-702
Certified Cor. Record Prepared? (Yes) No Filed At: BLM Co. SURVEYOR'S OFFICE Date

11

REMARKS
ORIG.: STONE 17x10x8 BURIED 9", W/ 1/4 ON W. FACE
BT'S: 6" FIR N 36° E 4.0 FT.
8" FIR N 64° W 7.2 FT.

12

Index File No. 0165T. 19 S, R. 8 E., W.M.

Tract or Surv. No.

Cor. P-01

13

USDA-FOREST SERVICE

Index

File No. 0167

CORNER RECORD (SEARCH)

(Ref. FSM 7151.4)

Tract or BLM

Survey No. 1000

Cor. No. R-01

T. 19 S. R. 8 E.

R.D. BEND

County DESCHUTES SW

Cor. of SEC. 19

Merid. WILLAMETTE

N.F. DESCHUTES

State OREGON NE

Cor. of SEC. 25

CORNER DIAGRAM PER LEGEND

S.24 S.19

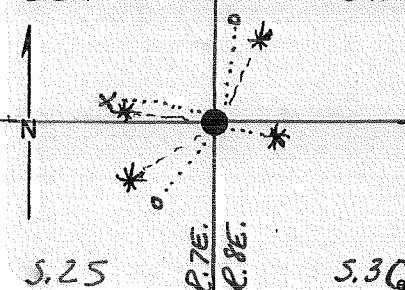

PHOTO IDENTIFICATION DATA

Photo No. _____

Filed At. _____

Object Ident. _____

Ident. By _____

Signature _____

DESCRIBE CORNER MONUMENT FOUND

STONE 17" X 12" X 6" RSG. 3" ~ ~~NO MARKS~~
A NOTCHES

DESCRIBE BEARING TREES OR OTHER OFFICIAL ACCESSORIES FOUND

S.24: 15" LP, DEAD TOP ~~N 78° W~~ ^{348°} 55 FT. ~ BLAZE HEALED, SCR. VIS.

S.25: ROTTED STUMP S 38° W 23 FT. ~ VIS: T 9 R 7 S 2 S

S.30: 16" LP S 74° E 11 ²¹ FT. ~ FACE BLAZE HEALED

S.19: STUMP & LOG N 08° E 52 ²³ FT. ~ VIS: BT

DESCRIBE CORNER LOCATION RELATIVE TO NEAR-BY FEATURES, ALSO HOW TO REACH CORNER

PLACED BT TAGS ON STANDING BTs - ALSO ATTN. SIGNS

Corner Legend:

○ Searched for/Not Found

⊗ Evidence Found/Accept.

● Permanent Monument

Signature W. MILLER

Title S.T.

Division _____

Headquarters S.O.

Date 9/81 O-7100-52 (3/79)

CORNER RECORD (PERPETUATION)

MONUMENT DESCRIBE NEW MONUMENT SET, OR WORK DONE TO PRESERVE EXISTING MONUMENT

SET 2 1/2" x 30" ACAP REG. 3" IN MD./STONE, 2 1/2' x 15" high,
ON GENTLE WEST SLOPE. BURIED ORIG. STONE ALONGSIDE
PIPE.

MONUMENT SET/DATE

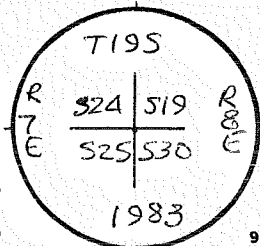

ACCESSORIES DESCRIBE NEW BT'S WITNESS OBJECTS ETC. ESTABLISHED, OR WORK DONE TO PRESERVE EXISTING EVIDENCE

1 3" SUGAR PINE N 8 1/4 W 26³⁰ FT. TO 60d NL. IN N. BASE, MKD. T195 R 7E S24 BT
6" L. PINE N 21 3/4 E 56¹⁰ FT. TO 60d NL. in SE BASE, MKD. T195 R 8E S19 BT
16" L. PINE S 72 1/2 E 11² FT. TO 60d NL. in NNE BASE, (ORIG.)
4" L. PINE S 58 1/2 W 24³⁰ FT. TO 60d NL. in SE BASE, MKD. X BT

Work Done By ROMAN Title PLS Date 10/82 State Registration No. OR-702
or Agency
PLAT PREPARED OR
Certified Cor. Record Prepared? Yes No Filed At: BLM Co. SURVEYOR'S OFFICE Date

REMARKS

ORIG.: SLATE STONE 18x12x7 BURIED 10", MKD. 2 NOTCHES S, 1 A NOTCHES N.
BT'S: 10" BLACK PINE N 12 E 52¹ FT.
9" " " S 71 E 10⁶ FT.
12" " " S 40 W 21⁸ FT.
8" " " N 72 W 34³ FT.

Index File No. 0167 T. 19 S., R. 8 E., W.M.

Tract or Surv. No.

Cor. R-01

Index
File No. _____

CORNER RECORD (SEARCH)

(Ref. FSM 7151.4)

Tract or Survey No. 1029 Cor. No. R-13

T 195 R. 8

R.D. Bend/FT Rock County Deschutes S.E. Cor

Merid. W.M

N.F. Deschutes State OR Section 21

CORNER DIAGRAM

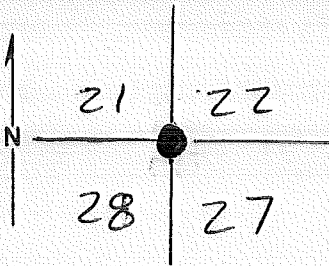

DESCRIBE CORNER MONUMENT FOUND

FD Stone 18" x 12" x 6" w/ chisel marks
2 on S. side, 3 on East - stone mound
approx 2' SE

DESCRIBE BEARING TREES OR OTHER OFFICIAL ACCESSORIES FOUND

none confirmed

PHOTO IDENTIFICATION DATA

Photo No. _____
Filed At. _____
Object Ident. _____
Ident. By _____
Signature

DESCRIBE CORNER LOCATION RELATIVE TO NEAR-BY FEATURES, ALSO HOW TO REACH CORNER

old tag @ intersection of RD 515 SE
of 520 RD Approx 600' North of corner
Tag on Lpp on NE side of intersection
Approx 10 chs N. of corner

PLANE COORDINATE POSITION DATA

State _____ Zone _____
X _____
Y _____
Estab. By _____
Agency

Signature

Title Division

Headquarters

Date

FS-7100-52 (3/68)

S. J. Smith

Sur Tech CS

Bend/so

10/16/98

CORNER RECORD (PERPETUATION)

MONUMENT: DESCRIBE NEW MONUMENT SET, OR WORK DONE TO PRESERVE EXISTING MONUMENT

Set 2 1/2 dia. x 30" BCSP rising 6" in mound
of stone. Orig. stone buried along side
steel post 3' North.

T 195
S21 522 R
S28 1527 E
PLS 2111
1998

ACCESSORIES : DESCRIBE NEW BT'S WITNESS OBJECTS ETC. ESTABLISHED, OR WORK DONE TO PRESERVE EXISTING EVIDENCE

LP pine 10" Dia N 27° E 36.7 FT mkd T 195 R 8 E S 22 BT
Spruce 10" " S 58° E 42.4' " " " S 27 BT
Spruce 7" " S 40° W 54.4' " X BT
Subalpine Fir 3" " N 45° W 47.4' " X BT

Work Done By WB Ham Title PLS Date 9/11/98 State Registration No. 2111
or Agency

Certified Cor. Record Prepared? Yes No Filed At: Deschutes Co Date

REMARKS

Orig survey set; sandstone 18x12x6 ins 12" in ground 2 notches S 3 E
A.B. Pine 9" N 48° E 31 LKS (20.5')
" " 8" S 87° E 71 LKS (46.9')
" " 10" S 36° W 49 LKS (32.3')
" " 7" N 89° W 51 LKS (33.7')

Index File No. T. 195 R. 8 E M. W.I. Tract or Surv. No. 1029 Cor. R13

USDA-FOREST SERVICE

Index File No. 0169

CORNER RECORD (SEARCH)
(Ref. FSM 7.151.4)

Tract or Survey No. BLM 1000

Cor. No. T-01

T. 19 S. R. 8 E. R.D. BEND County DESCHUTES W/4 COR. of SEC 30
Merid. WILLAMETTE N.F. DESCHUTES State OREGON E/4 COR. of SEC. 25

CORNER DIAGRAM PER LEGEND

S.25

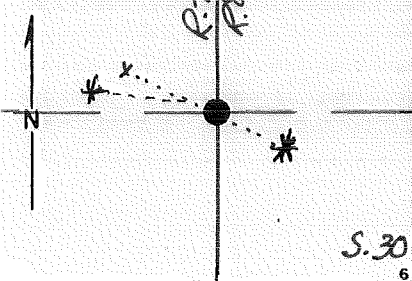

DESCRIBE CORNER MONUMENT FOUND

STONE 15" X 9" X 6" N.1/4. 1/4 ON W. FACE, R8G. 3", HIT BY TREE.

DESCRIBE BEARING TREES OR OTHER OFFICIAL ACCESSORIES FOUND

S.25: 16" HEMLOCK N51¹⁵/₂°W ¹⁵⁸14.9 FT. NEAR BLADE
S.30: 9" " S66¹²/₄°E ¹²¹11.23 FT. " "

PHOTO IDENTIFICATION DATA

Photo No. _____
Filed At. _____
Object Ident. _____
Ident. By _____
Signature _____

DESCRIBE CORNER LOCATION RELATIVE TO NEAR-BY FEATURES, ALSO HOW TO REACH CORNER

SET GUARD POST AND BT, ATTN. SIGNS

Corner Legend:

- Searched for/Not Found
- Evidence Found/Accept.
- Permanent Monument

Signature W. MILLER

Title S.T. Division _____

Headquarters S.O.

Date 9/81 D-7100-52 (3/79)

CORNER RECORD (PERPETUATION)

MONUMENT SET/REPLACED

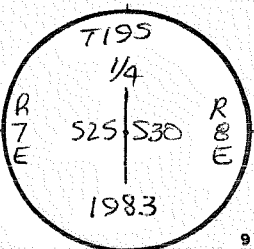

MONUMENT DESCRIBE NEW MONUMENT SET, OR WORK DONE TO PRESERVE EXISTING MONUMENT
 SET 2 1/2 x 30" ACAP RSG. 8" IN MDI/STONE, 2 1/2' x 15" high, NEAR
 TOP of N-S RIDGE ON EAST SLOPE. BURIED ORIG. STONE
 ALONGSIDE PIPE.

ACCESSORIES DESCRIBE NEW BT'S WITNESS OBJECTS ETC. ESTABLISHED, OR WORK DONE TO PRESERVE EXISTING EVIDENCE

9" HEMLOCK S65 3/4 E 11²³ FT. TO 60d NL. - BASE, (ORIG.)
 8" HEMLOCK N79°W 24³⁰ FT. TO 60d NL. in S. BASE, MKD. 1/4 S25 13T

Work Done By R. OMAN Title PLS Date 10/82 State Registration No. OR-702
 or Agency
 Certified Cor. Record Prepared Yes No Filed At: BLM Co. SURVEYOR'S OFFICE Date

REMARKS

ORIG. SLATE STONE 15 x 10 x 9 BURIED 8", MKD. 1/4 ON W. FACE
 BT'S: 6" FIR S65E 11² FT.
 12" SPRUCE N50W 14⁵ FT.

Index File No. 0169 T. 19 S., R. 8 E., W.M.

Tract or Surv. No.

Cor. T-01

USDA-FOREST SERVICE

Index
File No. 1369

CORNER RECORD (SEARCH)

(Ref. FSM 7151.4)

Tract or
Survey No. _____

Cor.
No. T-13

T 19 S R. 8 E

R.D. Bend County Deschutes

W/4 Sec 27

Merid. WMT

N.F. Deschutes State Oregon

CORNER DIAGRAM

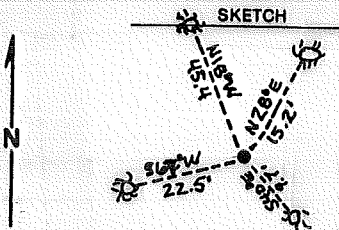

DESCRIBE CORNER MONUMENT FOUND

Found stone 19 x 10 x 6 marked 1/4 on the W. face, leaning but still in its original bed. There were rotted remains of the bearing trees in location, but no marks could be found.

PHOTO IDENTIFICATION DATA

Photo No. _____

Filed At. _____

Object Ident. _____

Ident. By _____

Signature

DESCRIBE CORNER LOCATION RELATIVE TO NEAR-BY FEATURES, ALSO HOW TO REACH CORNER

PLANE COORDINATE POSITION DATA

State _____ Zone _____

X _____

Y _____

Estab. By _____

Agency

Signature

Watt Muller

Title

PLS

Division

OS

Headquarters

SO

Date

11/95

FS-7100-52 (3/68)

CORNER RECORD (PERPETUATION)

MONUMENT: DESCRIBE NEW MONUMENT SET, OR WORK DONE TO PRESERVE EXISTING MONUMENT

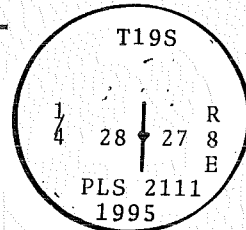

In the place of the stone, I set a 2½" x 30" Aluminum Capped Aluminum Pipe rising 3" in a stone collar. I buried the Original Stone alongside. I established the following accessories:

- A 5" Lodgepole Pine bears N28°E at 15.2 ft., marked X BT.
- A 6" Lodgepole Pine bears S40°E at 9.7 ft., marked 1/4 S27 BT.
- A 5" Lodgepole Pine bears S67°W at 22.5 ft., marked X BT.
- A 8" Lodgepole Pine bears N18°W at 45.4 ft., marked 1/4 S28 BT.

VE EXISTING EVIDENCE

A brass washer marked PLS 2111 was installed between the scribed B and T on each tree. Distances were measured to the side-center of each tree.

10

Work Done By Walt Miller Title PLS Date 11/95 State Registration No. 2111
or Agency _____

Certified Cor. Record Prepared? Yes No Filed At: Des Date _____

11

REMARKS

July 25, 1995 - Samuel W. Lackland under Group No. 458, established the sectional subdivision lines for T19S, R8E. He set this corner as follows:

Set slate stone 17x 12 x 6 ins. 11 ins in ground for 1/4 sec. cor. marked 1/4 on W. face; from which

- A B.Pine 8 ins. dia. brs. S.46°W. 23 lks. dist. marked 1/4 S.B.T.
- A B.Pine 6 ins. dia. brs. N.59°E. 31 lks. dist. marked 1/4 S.B.T.

12

Index File No.	T.	R.	M.	Tract or Surv. No.	Cor.
1369	19	8		GPO: 1986 O- 439-095	T-13

13

USDA-FOREST SERVICE

Index File No. 0171

CORNER RECORD (SEARCH)

(Ref. FSM 7151.4)

Tract or Survey No. BLM 1000

Cor. No. V-01

T. 19 S. R. 8 E.

R.D. BEND

County DESCHUTES

SW COR. of SEC. 30

Merid. WILLAMETTE

N.F. DESCHUTES

State OREGON

NE COR. of SEC. 36

CORNER DIAGRAM PER LEGEND

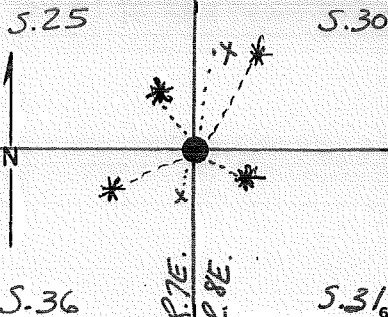

DESCRIBE CORNER MONUMENT FOUND

STONE 18" X 11" X 10° RSG. 10"; 5 NOTCHES ON N. EDGE

DESCRIBE BEARING TREES OR OTHER OFFICIAL ACCESSORIES FOUND

- S.25: 15" HEMLOCK N22°W 10³¹ FT. ~ FACE BLAZE
- S.30: 8" " (SNAG) N12°E 25⁵ FT. ~ VIS: T19SR8E S30 BT
- S.31: 13" " S58°E 10¹⁸ FT. ~ FACE BLAZE
- S.36: 18" " (SNAG) 25' HI. S11°W 8³ FT. ~ VIS: T19SR7E S36 BT

PHOTO IDENTIFICATION DATA

Photo No. _____
 Filed At. _____
 Object Ident. _____
 Ident. By _____

DESCRIBE CORNER LOCATION RELATIVE TO NEAR-BY FEATURES, ALSO HOW TO REACH CORNER

SET GUARD POST
 PLACED BT & ATTN. SIGNS ON STANDING TREES

- Corner Legend:
- Searched for/Not Found
 - Evidence Found/Accept.
 - Permanent Monument

Signature W. MILLER

Title S.T. Division _____

Headquarters S.O.

Date 9/810-7100-52 (3/79)

CORNER RECORD (PERPETUATION)

MONUMENT. DESCRIBE NEW MONUMENT SET, OR WORK DONE TO PRESERVE EXISTING MONUMENT

SET 2 1/2" X 30" ACAP RSG. 5" IN MD. / STONE, 2 1/2' X 12" high,
NEAR TOE OF GENTLE NORTH SLOPE. BURIED ORIG. STONE
ALONGSIDE PIPE.

MONUMENT SET/REPLACED

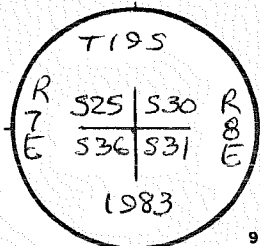

9

ACCESSORIES. DESCRIBE NEW BT'S WITNESS OBJECTS ETC. ESTABLISHED, OR WORK DONE TO PRESERVE EXISTING EVIDENCE

14" HEMLOCK N12 3/4 E 29 1/2 FT. TO SW/NE. W. BASE, MKD. T195 R8E S30 BT
13" HEMLOCK S59 1/2 E 10 1/8 FT. " " " " S. " (ORIG.)
15" HEMLOCK S69 3/4 W 18 1/4 FT. " " " " NNW ", MKD. T195 R7E S36 BT
15" HEMLOCK N21 1/2 W 10 3/4 FT. " " " " NNE " (ORIG.)

10

Work Done By R. OMAN Title PLS Date 10/82 State Registration No. OR-762
 or Agency
 PLAT PREPARED OR
 Certified Cor. Record Prepared? Yes No Filed At: BLM Co. SURVEYOR'S OFFICE Date

11

REMARKS

ORIG. SANDSTONE 18 X 15 X 12 RSG. 8", MKD. 1 NOTCH ON S, & 5 NOTCHES ON N.
 BT'S: 10" BLACK PINE N09°E 24 1/2 FT.
 9" SPRUCE S56°E 9 3/4 FT.
 16" FIR S12°W 7 3/4 FT.
 10" FIR N20°W 9 3/4 FT.

12

Index File No. 0171 T. 19 S., R. 8 E., W.M.

Tract or Surv. No.

Cor. V-01

13

USDA-FOREST SERVICE

CORNER RECORD (SEARCH)

Tract or Survey No. _____

Cor. No. V-08

05'

Index File No. 0671

T 19 S R. 8 E

R.D. Dee Bend County Deschutes

Merid. Wmt

N.F. Deerates State Oreg

SW/4 Sect. 29

CORNER DIAGRAM

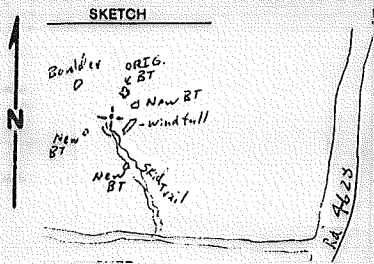

DESCRIBE CORNER MONUMENT FOUND

SF/NF

DESCRIBE BEARING TREES OR OTHER OFFICIAL ACCESSORIES FOUND

DESCRIPTION OF CORNER EVIDENCE FOUND:

Searched for but did not find the original stone. The area has been disturbed by logging activities. Set corner in position determined from NE BT, which is a broken off Fir, 24" dia. N.10°E. 24 lks.(15.8 ft.) with scribing exposed. A Hemlock windfall is generally in the SE BT location, with scribing exposed. It has been moved from its original location by the logging activities. No evidence of the SW or NW BT's was found at this time.

PHOTO IDENTIFICATION DATA

Photo No. _____
 Filed At. _____
 Object Ident. _____
 Ident. By _____
 Signature _____

PLANE COORDINATE POSITION DATA

State _____ Zone _____
 X _____
 Y _____
 Estab. By _____
 Agency _____

DESCRIBE CORNER LOCATION RELATIVE TO NEAR-BY FEATURES, ALSO HOW TO REACH CORNER

Signature William B Ham

Title PLS

Division CS

Headquarters SO

Date 10/94

FS-7100-52 (3/68)

CORNER RECORD (PERPETUATION)

MONUMENT: DESCRIBE NEW MONUMENT SET, OR WORK DONE TO PRESERVE EXISTING MONUMENT

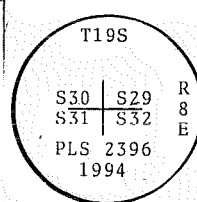

A 2½"dia. x 30" long steel pipe surmounted by a 2½"dia. brass cap rising 14" above ground. A penny at base of pipe. Steel fence post N.30°E. 5ft.
 A Lodgepole pine 5"dia. N.50°E., 14.3ft. mkd. T19S R8E S29 BT
 A Hemlock 8"dia. S.26°E., 55.6ft mkd T19S R8E S32 BT
 A Subalpine fir 4"dia. S.36°W., 17.0ft. mkd. X BT
 A Boulder 3'x3' rising 1ft, N.72°W., 24.9ft. mkd. X BO (measured to the X)
 Bearings by hand compass. Distances to side center at root crown. A brass washer marked LS 2396 nailed between the B & T of the scribing.
 A location poster on logging road 95ft. S. of corner. A location poster on Rd. 4628 760ft. East of corner.

IE TO PRESERVE EXISTING EVIDENCE

10

Work Done By William B. Hena Title PLS Date 10/3/94 State Registration No. 2396
 Certified Cor. Record Prepared? Yes No Filed At: Des Moines IA Date 10/3/94
 For Agency _____

11

REMARKS

HISTORY OF ORIGINAL CORNER AND/OR PREVIOUS RENEWALS: Survey of 1883 by Samuel W. Lackland
 Set basalt stone 16x12x8 ins. 10 ins. in ground for cor. to secs. 29, 30, 31
 32 marked with 1 notch on S. & 5 notches on E. edges: from which
 A Spruce 18 ins. dia. brs. N.10°E. 24 lks. dist. marked T.19S.R.3E.S.29 B.T.
 A Hemlock 6ins. dia. brs. S.75°E. 39 lks. dist. marked T.19S.R.8E.S.32 B.T.
 A Hemlock 8ins. dia. brs. S.30°W. 13 lks. dist. marked T.19S.R.8E.S.31 B.T.
 A Spruce 6ins. dia. brs. N.61°W. 7 lks. dist. marked T.19S.R.8E.S.30 B.T.

12

Index File No. 0571 T. 19 R. 8 M. _____ Tract or Surv. No. _____ Cor. V-05
 GPO: 1986 O-439-095

Index File No. 1371

CORNER RECORD (SEARCH)
(Ref. FSM 7151.4)

Tract or Survey No. _____
Cor. No. V-13

T 195 R. 8 E
Merid. WMT

R.D. Bend County Deschutes
N.F. Deschutes State Oregon

NW Cor sec 34

CORNER DIAGRAM

DESCRIBE CORNER MONUMENT FOUND

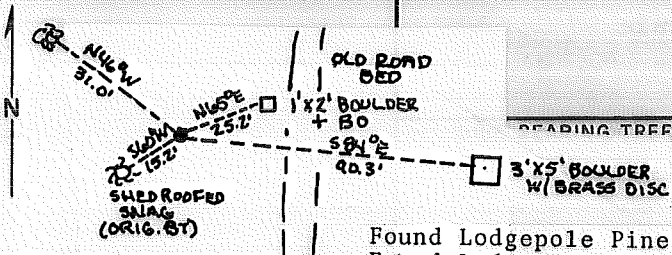

BEARING TREES OR OTHER OFFICIAL ACCESSORIES FOUND

PHOTO IDENTIFICATION DATA

Photo No. _____
Filed At. _____
Object Ident. _____
Ident. By _____

Found Lodgepole Pine snag 16" Diam. in SW location, with scribing visible.
Found Lodgepole Pine snag (broken off) 15" diam in NW location, with scribing visible. Using a Dist. - Dist. intersection from these 2 known positions, the NE location was determined to fall in an old road bed. The SE location had rotted remains in the area. The NE and SE bearing tree location are considered lost. There were no remains of the original post found in the area.

Signature

PLANE COORDINATE POSITION DATA

State _____ Zone _____
X _____
Y _____
Estab. By _____
Agency

Signature
Walt Muller

Title
PLS

Division
CS

Headquarters
SO

Date
11/95 FS-7100-52 (3/68)

CORNER RECORD (PERPETUATION)

MONUMENT: DESCRIBE NEW MONUMENT SET, OR WORK DONE TO PRESERVE EXISTING MONUMENT

Using the Dist. - Dist. intersection position as mentioned above; I set a 2½" X 30" Aluminum Capped Aluminum Pipe rising 4" above ground in a rock collar. I established accessories as follows:

A chisled "X B0" in a 1 ft. x 2' boulder on the W. side of the old road bed, bears N65°E at 25.2 ft.

A 3½" brass disc in a 3 ft. x 5' boulder on the E. side of the old road bed bears S84°E at 90.3 ft. This is an old benchmark marked P358 1942.

A 16" diam. Lodgepole Pine snag 5 ft. high bears S60°W at 15.2 ft. with visible scribing. (original B.T. - We cut down and shed roofed the snag.)

A 3" Lodgepole Pine bears N46°W at 31.0 ft., marked X BT. A brass washer was installed in the scribe between the B and T.

Bearings were taken with a Sipe-Sumner Staff Compass with a 19°E decl.

~~Distances were measured to the side-center of each tree.~~

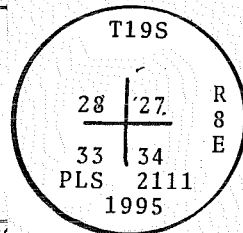

9

10

Work Done By: Walt Miller Title: PLS Date: 11/95 State Registration No. or Agency: 2111

Certified Cor. Record Prepared? Yes No Filed At: Des Cor Date: 11

July 25, 1882 - Samuel W. Lackland under Group No. 458, established the sectional subdivision lines for T19s, R8E. He set this corner as follows:

Set a post 4 ft. long 4 ins. sqr. 24 ins in ground for cor. to secs 27, 28, 33, & 34 marked T.19S. S.27 on N.E. R.8E. S.34 on S.E. S.33 on S.W. and S.28 on N.W. faces, with 1 notch on S. & 3 notches on E. edges; from which A B.Pine 10 ins. dia. brs. N.41°E. 45 lks dist. marked T.19S.R.8E. S.27B.T. A. B.Pine 10 ins. dia. brs. S.78°E. 25 lks dist marked T.19S. R.8E.S34B.T. A B.Pine 12 ins. dia. brs. S.63°W. 23 lks dist marked

12

Index File No. 1371 T. 19 R. 8

T.19S.R.8E.S.33B.T. A B.Pine 14 ins. dia. brs. N.40°W. 49 lks dist marked T.19S.R.8E. S.28B.T.

V-13 13

USDA-FOREST SERVICE

Index File No. 0173

CORNER RECORD (SEARCH)

(Ref. FSM 7.151.4)

Tract or Survey No.

Cor. No. X-01

T. 19 S. R. 8 E. R.D. BEND County DESCHUTES W/4 COR. of SEC. 31
Merid. WILLAMETTE N.F. DESCHUTES State OREGON E/4 COR. of SEC. 36

CORNER DIAGRAM PER LEGEND

S.36

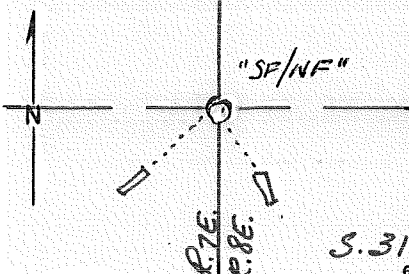

DESCRIBE CORNER MONUMENT FOUND

NONE

DESCRIBE BEARING TREES OR OTHER OFFICIAL ACCESSORIES FOUND

12" LP, D&D, VIS: 1/4 5 BT } SF/NF
12" LP " " " " } Red 10/82

PHOTO IDENTIFICATION DATA

Photo No. _____
Filed At. _____
Object Ident. _____
Ident. By _____

TRIED ALL MANNER OF THEORIES BUT COULD NOT FIT BT'S IN VIABLE PATTERN. COMPUTED INVERSE IS N(S)73°08'(E)W 53.6 LKS. FIELD POSITIONS ARE N(S)84°(E)W 106.1 LKS. SO DID NOT SET.

DESCRIBE CORNER LOCATION RELATIVE TO NEAR-BY FEATURES, ALSO HOW TO REACH CORNER

SET GUARD POST & BT TAGS

Corner Legend:

- Searched for/Not Found
- Evidence Found/Accept
- Permanent Monument

Signature W. MILLER

Title S.T. Division

Headquarters S.O.

Date 9/81 D-7100-52 (3/79)

CORNER RECORD (PERPETUATION)

MONUMENT. DESCRIBE NEW MONUMENT SET, OR WORK DONE TO PRESERVE EXISTING MONUMENT

MONUMENT SET

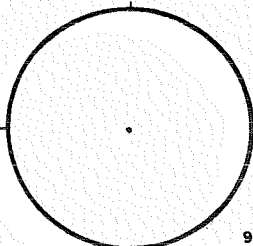

9

ACCESSORIES DESCRIBE NEW BT'S WITNESS OBJECTS ETC. ESTABLISHED, OR WORK DONE TO PRESERVE EXISTING EVIDENCE

10

Work Done By _____ Title _____ Date _____ State Registration No. _____
or Agency _____
PLAT PREPARED OR
Certified Cor. Record Prepared? Yes No Filed At. **Co. SURVEYOR'S OFFICE** Date _____

11

REMARKS

Index File No. **0173 T. 19 S., R. 8 E., W.M.** Tract or Surv. No. Cor. **X-01**

12

13

USDA-FOREST SERVICE

Index File No. 0175

CORNER RECORD (SEARCH)

(Ref. FSM 7.151.4)

Tract or Survey No. BLM 1000

Cor. No. 7-01

T. 19 S. R. 8 E. R.D. BEND County DESCHUTES SW COR. of SEC. 31

Merid. WILLAMETTE N.F. DESCHUTES State OREGON NE COR. of SEC. 1

CORNER DIAGRAM PER LEGEND

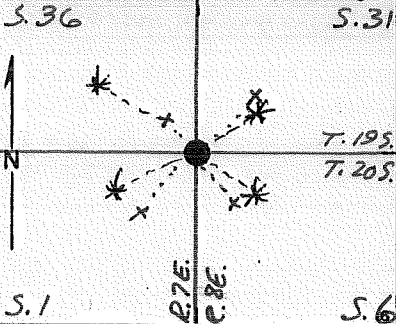

DESCRIBE CORNER MONUMENT FOUND

STONE 10" X 20" X 8" RSG. 10", WELL BEDDED MKD. 6 NOTCHES ON EACH SIDE (N-E-W-S)

DESCRIBE BEARING TREES OR OTHER OFFICIAL ACCESSORIES FOUND

- S.36: D&D N54°W 47 FT. ~ VIS: T19S R7E S36 BT
- S.31: " N34°E 20² FT. ~ VIS: T19S R8E S31 BT
- S.6: " S23°E 116 FT. ~ VIS: T20S R8E S6 BT
- S.1: " S38°W 20° FT. ~ VIS: S1R7E S1 BT

PHOTO IDENTIFICATION DATA

Photo No. _____
Filed At. _____
Object Ident. _____
Ident. By _____

DESCRIBE CORNER LOCATION RELATIVE TO NEAR-BY FEATURES, ALSO HOW TO REACH CORNER

SET GUARD POST & BT TAGS.

Corner Legend:

- Searched for/Not Found
- Evidence Found/Accept.
- Permanent Monument

Signature W. MILLER Title S.T. Division _____ Headquarters S.O. Date 9/8/10-7100-52(3/79)

CORNER RECORD (PERPETUATION)

MONUMENT: DESCRIBE NEW MONUMENT SET, OR WORK DONE TO PRESERVE EXISTING MONUMENT

SET 2 1/2" x 30" A.C.P. RSG. 5" IN MD./STONE, 2' x 12" high, ON NW SLOPE NEAR NOSE OF N-S RIDGE. BURIED ORIG. STONE ALONGSIDE PIPE

MONUMENT SET DATE

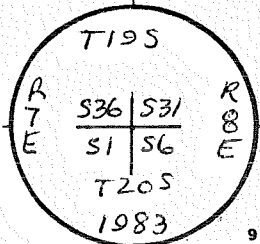

ACCESSORIES: DESCRIBE NEW BT'S WITNESS OBJECTS ETC. ESTABLISHED, OR WORK DONE TO PRESERVE EXISTING EVIDENCE

5" L. PINE N 45° E 16²⁸ FT. TO 60d NL. in NW BASE, MKD. T19S R8E S31 BT
 3" L. PINE S 41 1/2° E 14⁶³ FT. TO 60d NL. in NE BASE, MKD. X BT
 4" L. PINE S 60 1/2° W 16²¹ FT. TO 60d NL. in NW BASE, MKD. X BT
 4" L. PINE N 49 1/2° W 42⁹⁵ FT. TO 60d NL. in NE BASE, MKD. X BT

Work Done By R. DUMAN Title PLS Date 10/82 State Registration No. or Agency OR-702
 PLAT PREPARED OR Certified Cor. Record Prepared? Yes No Filed At BLM Co. SURVEYOR'S OFFICE Date _____

REMARKS

ORIG.: SANDSTONE 20 X 14 X 10 BURIED 15", MKD. 6 NOTCHES ON EACH EDGE
 BT'S: 6" BLACK PINE N 45° E 21¹ FT.
 6" " " S 23° E 11² FT.
 6" " " S 38° W 19⁸ FT.
 7" " " N 54° W 4⁶ FT.

Index File No. 0175-T. 19 S., R. 8 E., W.M.

Tract or Surv. No.

Cor. Z-01

USDA-FOREST SERVICE

Index

File No. 0375

CORNER RECORD (SEARCH)

(Ref. FSM 7.151.4)

Tract or Survey No. BLM 1000

Cor. No. 2-03

T. 19 S. R. 8 E. R.D. BEND County DESCHUTES S/A COR. of SEC. 31

Merid. WILLAMETTE N.F. DESCHUTES State OREGON N/A COR. of SEC. 6

CORNER DIAGRAM PER LEGEND

S.31

DESCRIBE CORNER MONUMENT FOUND

STONE 13" X 12" X 5" RSG. 8" MKD. 1/4

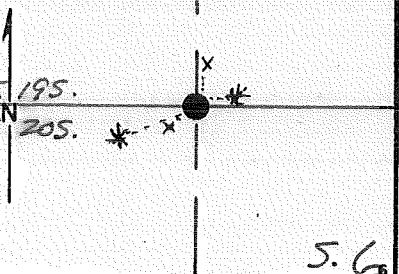

DESCRIBE BEARING TREES OR OTHER OFFICIAL ACCESSORIES FOUND

S.31: D&D N01°E 76 FT. ~ MKS. VIS. BUT UNREADABLE

PHOTO IDENTIFICATION DATA

Photo No. _____

Filed At. _____

Object Ident. _____

Ident. By _____

Signature _____

S.6: D&D S59°W 33 FT. ~ VIS: 1/4 S

DESCRIBE CORNER LOCATION RELATIVE TO NEAR-BY FEATURES, ALSO HOW TO REACH CORNER

SET GUARD POST & BT TAGS

Corner Legend:

Searched for/Not Found

Evidence Found/Accept.

Permanent Monument

Signature W. MILLER

Title S.T. Division

Headquarters S.O.

Date 9/81 D-7100-52 (3/79)

CORNER RECORD (PERPETUATION)

MONUMENT. DESCRIBE NEW MONUMENT SET, OR WORK DONE TO PRESERVE EXISTING MONUMENT

SET 2 1/2" X 28" ACAP RSG. 20" IN A MO. STONE, 3' X 20" high,
ON A LOW RISING DOME. GROUTED AP TO BEDROCK.
BURIED ORIG. STONE ALONGSIDE PIPE.

MONUMENT SET/REPAIRED

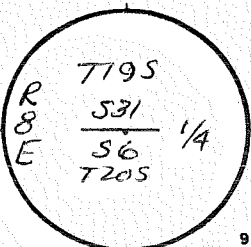

ACCESSORIES DESCRIBE NEW BT'S WITNESS OBJECTS ETC. ESTABLISHED, OR WORK DONE TO PRESERVE EXISTING EVIDENCE

4" L. PINE N 84 3/4 E 41 1/2 FT. TO 60d NL. ~ NNE BASE, MKD. X BT
5" L. PINE S 64 1/2 W 7 80 FT. TO 60d NL. ~ SSE BASE, MKD. X BT.

Work Done By R. OMAN Title PLS Date 10/82 State Registration No. OR-702
or Agency
Certified Cor. Record Prepared? Yes No Filed At: BLM Co. SURVEYOR'S OFFICE Date

REMARKS

ORIG.: SANDSTONE 14 X 10 X 10 BURIED 8", MKD. 1/4 ON N. FACE
BT'S: 10" PINE N 1 E 6 1/2 FT.
12" " S 60 W 2 0 FT.

Index File No. 0375 T. 19 S., R. 8 E., W.M. Tract or Surv. No. Cor. 2-03

USDA-FOREST SERVICE

Index File No. 0575

CORNER RECORD (SEARCH)
(Ref. FSM 7.151.4)

Tract or Survey No. BLM 1000

Cor. No. 2-05

T. 19 S. R. 8 E. R.D. BEND County DESCHUTES SE COR. of SEC. 31
Merid. WILLAMETTE N.F. DESCHUTES State OREGON NW COR. of SEC. 5

CORNER DIAGRAM PER LEGEND
S.31 S.32

DESCRIBE CORNER MONUMENT FOUND

STONE 16" X 12" X 11" RSG. 6", MKD. WITH
POSSIBLY 5 NOTCHES

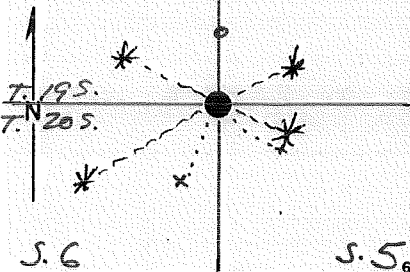

DESCRIBE BEARING TREES OR OTHER OFFICIAL ACCESSORIES FOUND

S.31: SF/HF
S.32: 5" STUMP N01°E 27 3/4 FT ~ VIS: BT
S.5: 12" D&D S46°E 13 1/2 FT ~ VIS: T20S R8E SS BT
S.6: D&D S13°W 18° FT VIS: T20S R8 BT

PHOTO IDENTIFICATION DATA

Photo No. _____
Filed At. _____
Object Ident. _____
Ident. By _____
Signature _____

DESCRIBE CORNER LOCATION RELATIVE TO NEAR-BY FEATURES, ALSO HOW TO REACH CORNER

SET GUARD POST & BT TAG

Corner Legend:

- Searched for/Not Found
- Evidence Found/Accept.
- Permanent Monument

Signature W. McCLER

Title S.T. Division

Headquarters

S.D. Date 9/8/07 D-7100-52 (3/79)

CORNER RECORD (PERPETUATION)

MONUMENT. DESCRIBE NEW MONUMENT SET, OR WORK DONE TO PRESERVE EXISTING MONUMENT

SET 2 1/2" x 30" ACAP RSG. 3" IN MD/STONE, 2' x 12" high,
± 100 FT. W. of RIDGETOP, ON GENTLE W. SLOPE, ± 10 FT. E.
of BOTTOM of Hollow. BURIED ORIG. STONE ALONGSIDE
PIPE.

MONUMENT STARTED

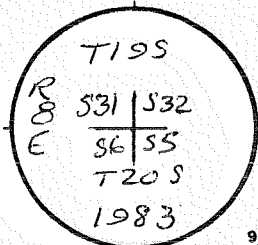

ACCESSORIES DESCRIBE NEW BT'S WITNESS OBJECTS ETC. ESTABLISHED, OR WORK DONE TO PRESERVE EXISTING EVIDENCE

4" L. PINE N56 1/2 E 15 7/8 FT. TO 60d NL. in SE BASE, MKD. X BT
6" W. FIR S68 E 24 2/4 FT. TO 60d NL. in NE BASE, MKD. T20 S RBE S5 BT
10" W. FIR S58 1/4 W 44 9/3 FT. TO 60d NL. in NW BASE, MKD. T20 S RBE S6 BT
5" L. PINE N59 3/4 W 24 9/6 FT. TO 60d NL. in NE BASE, MKD. T195 RBE S31 BT

Work Done By R. OMAN Title PLS Date 10/82 State Registration No. OR-702
or Agency
Certified Cor. Record Prepared? (Yes) No Filed At: BLM CO. SURVEYOR'S OFFICE Date

REMARKS

ORIG. : BASALT STONE 17x12x10 BURIED 12", MKD. 5 NOTCHES on E, & 1 NOTCH on W.
BTS: 8" PINE N1E 26 2 FT.
12" PINE S48E 14 5 FT.
10" PINE S18W 17 8 FT.
12" PINE N38W 13 2 FT.

Index File No. 0575 T. 19 S., R. 8 E., W.M.

Tract or Surv. No.

Cor. 2-05

USDA-FOREST SERVICE

Index File No. 0775

CORNER RECORD (SEARCH)

(Ref. FSM 7.151.4)

Tract or Survey No. BLM 1000

Cor. No. Z-07

T. 19 S. R. 8 E. R.D. BEND County DESCHUTES 3/4 COR. of SEC. 32

Merid. WILLAMETTE N.F. DESCHUTES State OREGON N/4 COR. of SEC. 5

CORNER DIAGRAM PER LEGEND
S.32

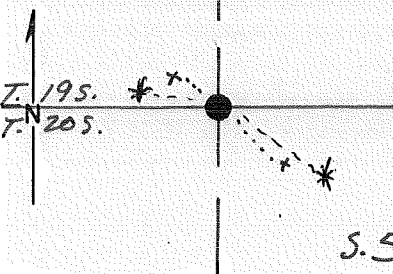

DESCRIBE CORNER MONUMENT FOUND

STONE 16" x 12" x 9" RSG. 4" ~ NO MARKS
MKD. 4

DESCRIBE BEARING TREES OR OTHER OFFICIAL ACCESSORIES FOUND

S.32: L.P., D&D, N42°W 48' ~ VIS: B.T.

S.5: 6" P.P., D&D, S32°E 16' ~ VIS: 1/4. 5

PHOTO IDENTIFICATION DATA

Photo No. _____
Filed At. _____
Object Ident. _____
Ident. By _____

Signature _____

DESCRIBE CORNER LOCATION RELATIVE TO NEAR-BY FEATURES, ALSO HOW TO REACH CORNER

SET GUARD POST & BT TAG

- Corner Legend:
- Searched for/Not Found
 - Evidence Found/Accept.
 - Permanent Monument

Signature W. MILLER

Title S.T. Division _____

Headquarters S.O.

Date 9/81 D-7100-52 (3/79)

CORNER RECORD (PERPETUATION)

MONUMENT: DESCRIBE NEW MONUMENT SET, OR WORK DONE TO PRESERVE EXISTING MONUMENT

2 1/2" X 30" ACAP RSG. 5" IN MD./STONE, 2' X 18" High,
ON GENTLE S. SLOPE IN LOGPOLE STAND. BURIED
ORIGINAL STONE ALONGSIDE PIPE.

MONUMENT STARTED

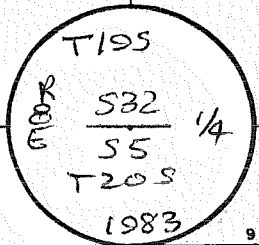

ACCESSORIES: DESCRIBE NEW BT'S, WITNESS OBJECTS ETC. ESTABLISHED, OR WORK DONE TO PRESERVE EXISTING EVIDENCE

7" L. PINE S34 1/2 E 37 1/2 FT. TO 60d NL. in SW BASE, MKD. 1/4 55 BT
4" L. PINE N77 3/4 W 8" FT. TO 60d NL. in NNE BASE, MKD. X BT

Work Done By R. ROMAN Title PLS Date 10/83 State Registration No. OR-702
or Agency
PLAT PREPARED OR
Certified Cor. Record Prepared? (Yes) No Filed At: BLM Co. SURVEYOR'S OFFICE Date

REMARKS

ORIG.: SANDSTONE 16X14 X 2 BURIED 10", MKD. 1/4 ON N. FACE
BT'S: 4" PINE S34 E 16 1/2 FT.
8" " N37W 46 FT.

Index File No. 0775 T. 19 S., R. 8 E., W.M.

Tract or Surv. No.

Cor. 2-07

USDA-FOREST SERVICE

Index

File No. 0975

T. 19 S. R. 8 E.

Merid. WILLAMETTE

CORNER RECORD (SEARCH)

(Ref. FSM 7.151.4)

Tract or Survey No.

Cor. No. 2-09

R.D. BEND County DESCHUTES

SE COR. of SEC. 32

N.F. DESCHUTES State OREGON

NW COR. of SEC. 4

CORNER DIAGRAM PER LEGEND

S.32 S.33



DESCRIBE CORNER MONUMENT FOUND

SF/NF

DESCRIBE BEARING TREES OR OTHER OFFICIAL ACCESSORIES FOUND

SF/NF

PHOTO IDENTIFICATION DATA

Photo No. _____

Filed At. _____

Object Ident. _____

Ident. By _____

Signature _____

DESCRIBE CORNER LOCATION RELATIVE TO NEAR-BY FEATURES, ALSO HOW TO REACH CORNER

Corner Legend:

Searched for/Not Found

Evidence Found/Accept.

Permanent Monument

Signature W. MILLER

Title S.T. Division

Headquarters S.O.

Date 9/81 D-7100-52 (3/79)

CORNER RECORD (PERPETUATION)

MONUMENT SET/REF

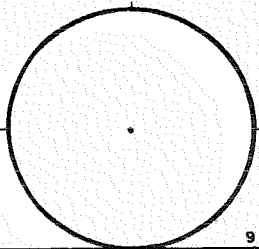

MONUMENT. DESCRIBE NEW MONUMENT SET, OR WORK DONE TO PRESERVE EXISTING MONUMENT

ACCESSORIES. DESCRIBE NEW BT'S WITNESS OBJECTS ETC. ESTABLISHED, OR WORK DONE TO PRESERVE EXISTING EVIDENCE

Work Done By _____ Title _____ Date _____ State Registration No. _____
or Agency _____
Certified Cor. Record Prepared? Yes No Filed At: **CO. SURVEYOR'S OFFICE** Date _____

REMARKS

ORIG.: POST 4x4 MKD. FOR COR.
BT'S: 7" PINE N7E 27¹ FT.
6" " S83E 46 FT.
5" " S2W 86 FT.
7" " N16W 93 FT.

Index File No. **0975 T. 19 S., R. 8 E., W.M.** Tract or Surv. No. _____ Cor. **2-09**

USDA-FOREST SERVICE

Index File No. 1175

CORNER RECORD (SEARCH)
(Ref. FSM 7.151.4)

Tract or Survey No. BLM 1000

Cor. No. 2-11

T. 19 S. R. 8 E.

R.D. BEND County DESCHUTES

S. 9 COR. of SEC. 33

Merid. WILLAMETTE

N.F. DESCHUTES State OREGON

N. 4 COR. of SEC. 4

CORNER DIAGRAM PER LEGEND

DESCRIBE CORNER MONUMENT FOUND

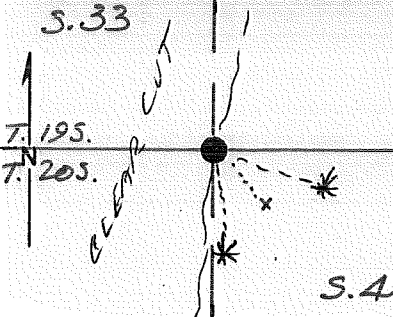

SF/NF

DESCRIBE BEARING TREES OR OTHER OFFICIAL ACCESSORIES FOUND

S. 4: 8" P. D&D ~ BLADE W/ SCR. ~ VIS: 'A 5 B 1'
S. 33: ROTTED LOG IN LOCATION

PHOTO IDENTIFICATION DATA

Photo No. _____
Filed At. _____
Object Ident. _____
Ident. By _____
Signature

DESCRIBE CORNER LOCATION RELATIVE TO NEAR-BY FEATURES, ALSO HOW TO REACH CORNER

SET GUARD POST & BT Tag.

Corner Legend:
 Searched for/Not Found
 Evidence Found/Accept.
 Permanent Monument

Signature W. MILLER

Title S.T. Division

Headquarters S.O.

Date 9/81 D-7100-52 (3/79)

CORNER RECORD (PERPETUATION)

MONUMENT DESCRIBE NEW MONUMENT SET, OR WORK DONE TO PRESERVE EXISTING MONUMENT

2 1/2" x 30" BCSP RSG. 8" IN MD. 1 STONE, 2' x 15" high,
ON NE SLOPE ALONG E. EDGE of CLEAR CUT UNIT.

MONUMENT SET/STAMPED

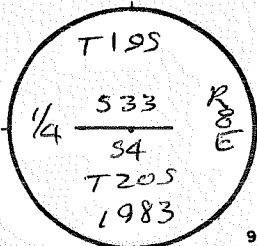

ACCESSORIES DESCRIBE NEW BT'S WITNESS OBJECTS ETC. ESTABLISHED, OR WORK DONE TO PRESERVE EXISTING EVIDENCE

8" L. PINE S75E 3525 FT. TO 60d NL. in NW BASE, MKD. 1/4 S4 BT
4" " S06 1/2 E 29 7/8 FT. TO 60d NL. in SW BASE, MKD. X BT

10

Work Done By R. ROMAN Title PLS Date 10/82 State Registration No. OR-702
or Agency
Certified Cor. Record Prepared? Yes No Filed At. BLM ~~Co. SURVEYOR'S OFFICE~~ Date

11

REMARKS

ORIG.: POST, 3" SQUARE, MKD. FOR COR.
BT'S: 4" PINE N28E 86 FT.
8" " S34E 92 FT.

12

Index File No. 1175 T. 19 S., R. 8 E., W.M. Tract or Surv. No. Cor. 2-11

13

Index File No. 1375 CORNER RECORD (SEARCH) (Ref. FSM 7151.4) Tract or Survey No. BLM 1000 Cor. No. 2-13
 T 19 S R. 8 E R.D. Band County Duch. SE Sec. Cor.
 Merid. Wm N.F. DES. State OR. Sec 33

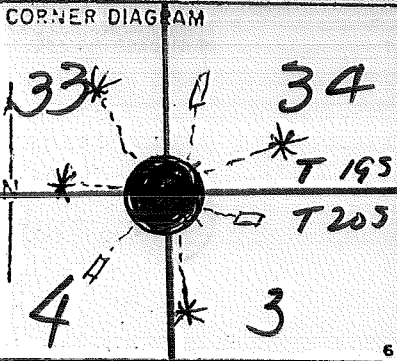

DESCRIBE CORNER MONUMENT FOUND
Stone
 9/81: STONE 14x16x7 - NO MARKS

PHOTO IDENTIFICATION DATA
 Photo No. _____
 Filed At. _____
 Object Ident. _____
 Ident. By _____
 Signature _____

DESCRIBE BEARING TREES OR OTHER OFFICIAL ACCESSORIES FOUND
~~4~~ BTs D&D
 10" SW MKD T 20 S R 8 E S 4 BT
 10" " SE " UNREADABLE S 3 BT
 6" " NE " T 19 S " S 34 BT
 DELAYED LOG IN NW LOCATION SCRIBE UNREADABLE

PLANE COORDINATE POSITION DATA
 State _____ Zone _____
 X _____
 Y _____
 Estab. By _____

DESCRIBE CORNER LOCATION RELATIVE TO NEAR-BY FEATURES, ALSO HOW TO REACH CORNER
 SET GUARD POST & BT TAGS

Signature W. MILLER Title CA BIGELOW FA Division CS Headquarters SO. Date 9/81
1/54 7100-52 (3 68)

CORNER RECORD (PERPETUATION)

MONUMENT
STAMPED:

MONUMENT: DESCRIBE NEW MONUMENT SET, OR WORK DONE TO PRESERVE EXISTING MONUMENT

2 1/2" X 30" BCSP RSG. 3" IN COLLAR of STONE, ON E. SLOPE,
± 85 FT. W. of W. BANK of SNOW CREEK, ± 600 FT. E. of
FOREST RD. #1945. BURIED STONE ALONGSIDE PIPE.

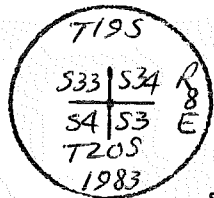

ACCESSORIES DESCRIBE NEW BT'S WITNESS OBJECTS ETC. ESTABLISHED, OR WORK DONE TO PRESERVE EXISTING EVIDENCE

14" SPRUCE N68 1/4 E 280 1/2 FT. TO LOD NL. S NNE BASE, MKD. T195 R8E S34 BT
9" " S03 1/2 E 315 1/2 FT. " " " " SW " , " T205 R8E S3 BT
4" L. PINE N85 1/2 W 98 1/2 FT. " " " " N " , MKD. X BT (NOTHING
8" W. FIR N36W 445 1/2 FT. " " " " SW " , MKD. T195 R8E S33 BT

Work Done By: R. OMAN Title: PLS Date: 10/82 State Registration No. or Agency: OR-702

Certified Cor. Record Prepared? Yes No Filed At: BLM OFFICE Date: _____

REMARKS

ORIG.: SLATE STONE 16 X 14 X 7 BURIED 10", MKD. 3 NOTICES E. & W.
BT'S: 7" PINE N47E 33 FT.
10" " S73E 33 FT.
10" S27W 17 1/2 FT.
9" PINE N25W 73 FT.

LAND CORNER RECORD

5680-2

19 8
T. 20S R. 15E No. 7-25 Cor. 3A Mer. ^{Set} ~~18~~ 2575 (Rectangular) State Oregon N.F. Washington Dist. Bend 7-25

2. Corner Status S

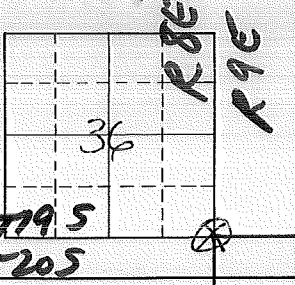

3. Original Description _____ Vol. _____ Page _____ Where Recorded _____

4. Description of Corners:
Stake in place
Fair condition

7. Photo Identification
Photo No. _____
Ident. By: _____

5. Investigation Notes:
One Bearing Tree -
Species:ponderosa Dead & Burned
Diameter
Bearing 214°
Distance 17'

8. Plane Coordinate Position Data
State _____ Zone _____
X _____
Y _____
Etab. By _____
Field Book No. _____
Where Filed _____

9. Evaluation
Authentic _____
Needs Verif. _____ Monument _____
Re-estab. _____ Survey _____
Land Status _____

6. Signed Leon Beaulieu Title Fire Control Aid Date 9-19-61

PERPETUATION RECORD

10. Monument :

11. Accessories

Field Book _____ Page _____

12. Set By _____ Title _____

13. Recorded By _____ (Agency) _____ Volume _____ Page _____

License _____ Agency _____ Date _____

(Date) _____ (City) _____ (County) _____ (State) _____

14. Remarks:

#2575

2-25